



Hi-Float® Inflator Instruction Sheet

Hi-Float® Inflator Includes:		1	Power Cord
1	Hi-Float® Inflator	1	Funnel
1	Helium Regulator	1	Squeeze Bottle
1	Hi-Float® Reserve cylinder	2	Cleaning Brushes
1	Foot Pedal Control	1	Measuring Cup

Set-Up Instructions



1. Unscrew the white cap with siphon tube from the Hi-Float® reserve cylinder.



2. Place the blue funnel into the cylinder and pour in 2 quarts of Hi-Float®. Replace the white cap with siphon on the cylinder and firmly tighten. (**Note: For maximum float time, use Super Hi-Float®.**)



3. Attach the clear Hi-Float® supply line to the reserve cylinder. Press the fitting firmly into the socket until the silver release lever makes a "click" sound. Gently pull the line to insure it is locked in place.



4. Repeat step 3 with the blue helium supply line.



5. Confirm the blue lever on the pressure bleed valve is pointing downward in the closed position.



6. Hand tighten the primary regulator to the helium cylinder.

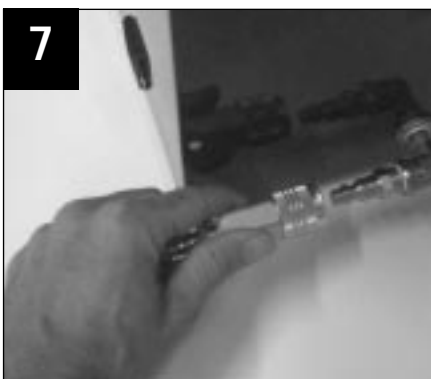

7. Press quick-fit connection on the helium supply line into the back of the unit. Slowly open the cylinder valve 5 full turns.



8. Plug the power cord and foot pedal into the side of unit.



9. Place the inflator near the edge of a clean smooth-surfaced counter. Press down firmly to secure the suction cups on the base of the inflator to counter. Remove blue cap from the Hi-Float® outlet.

Using Your Inflator

1. The Hi-Float® inflator has 3 modes of operation. Press the "Mode" button on the control panel to select the desired mode. The red LED display indicates in which mode the unit is operating. **Important:** When the setting is greater than 9.9, the display number will blink to indicate the setting exceeds 10.0. Add 10 to the blinking digit to calculate the setting.
2. Choose the Mode you would like to operate in and follow the directions below.

Mode 1: Automatically injects Hi-Float® ONLY into balloon (Red LED display ON left side only.)

Mode 2: Automatically Inflates balloon with Helium ONLY. (Red LED display ON right side only.)

Mode 3: Automatically injects Hi-Float® into balloon and inflates balloon with helium. (Both red LED displays ON.)



Mode 1

Fill Balloons with Hi-Float® Only

1. Set the unit to Mode 1. Reference the size setting chart to set the proper amount of Hi-Float®. To test the inflator, use the measuring cup to verify the amount of Hi-Float® being dispersed.
2. Slide the neck of the balloon all the way over the inflating outlet. There's a groove at the top of the outlet that will hold the balloon in place for hands-free operation.
3. Tap the foot pedal to begin the cycle.
4. Remove the balloon from the outlet and store in a cool, dry place until ready for inflation with helium. Wipe off any excess Hi-Float® from the aluminum outlet before replacing the blue outlet cap.

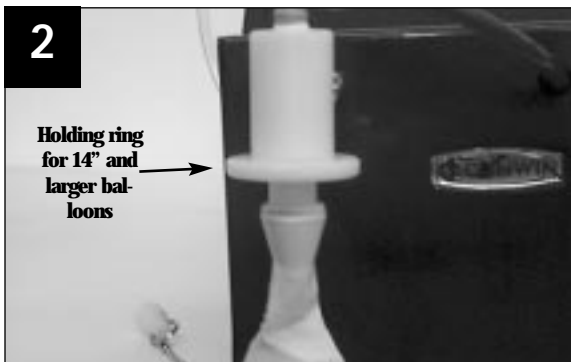

Mode 2

Inflating Latex Balloons with Helium Only

1. Set the unit to the Mode 2. Reference the size setting chart to set the proper amount of helium. (Note: It is not necessary to remove blue cap from the Hi-Float® outlet.)
2. Slide the neck of the balloon all the way over the inflating outlet. There's a groove at the top of the outlet that will hold the balloon in place for hands-free operation.
3. Tap the foot pedal to begin the automatic helium inflation process.
4. Remove the balloon from the outlet and tie.

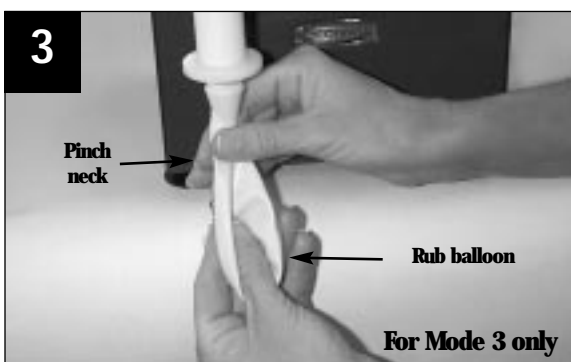

Mode 3

Inflating Latex Balloons with Hi-Float® and Helium

1. Set the unit to Mode 3. Reference the size setting chart to verify the preset amounts of Hi-Float® and helium.
2. Slide the neck of the balloon all the way over the inflating outlet. There's a groove at the top of the outlet that will hold the balloon in place for hands-free operation.
3. Tap the foot pedal to begin the cycle. Hi-Float® will enter the balloon first. After the Hi-Float® enters the balloon, pinch the neck of the balloon to prevent Hi-Float® from coating the outlet. Rub the balloon to evenly distribute the Hi-Float® and fully coat the inside of the balloon. After a 5 second delay the automatic helium inflation process begins. (NOTE: Tap the foot pedal twice to reduce the 5-second delay to 3 seconds.)
4. Remove the balloon from the outlet and tie. Wipe off any excess Hi-Float® from the aluminum outlet before replacing the blue outlet cap.



Troubleshooting: If the unit is not fully inflating balloons with helium, see the section on Inflator Maintenance on the back page of the instruction sheet.

Settings Chart

Balloon Size	Hi-Float® Test Amount	Mode 3 (Hi-Float® & Helium)	
		Mode 1 (Hi-Float®) seconds	Mode 2 (Helium) seconds
9"	1/2 tsp.	1.7	1.8
11"	1 tsp.	3.4	3.7
16"	2 tbsp.	11.7	9.7
18"	2+ tbsp.	12.3	13.8

Time settings are in seconds for both Hi-Float® and Helium. Set the unit to Mode 1 to test the amount of Hi-Float® injected placing the measuring cup under the outlet. **IMPORTANT:** Hi-Float® is temperature sensitive. Use this chart as a guideline and adjust as needed.



Adjusting Pressure

The second-stage helium regulator should be set at 70 PSI. To adjust the pressure, pull the knob up -- clockwise increases the pressure, counterclockwise decreases the pressure. Press the knob down to lock it in place.

Refilling the Reserve Cylinder

When the Hi-Float® level drops below the refill line on the sight tube, add 2 quarts of Hi-Float®.



1. Press the silver release tab on the helium supply line to remove the line from the cylinder. Repeat this process with the Hi-Float® supply line.



2. Open the pressure bleed valve on the Hi-Float® reserve cylinder cap to release the pressure from the cylinder. The valve is in the open position when the blue lever is in the horizontal position.



3. Repeat steps 1-5 of the Set-Up Instructions featured on front page.

Automatic Foil Balloon Inflation



Place the foil balloon over the brass inflating outlet. Pinch the neck of the balloon between your thumb and forefinger and press down on the outlet. Support the foil balloon in an upright position until enough helium has entered the balloon to hold it up. This insures the neck of the balloon does not fold over and restrict the flow of helium. When the balloon has reached the proper pressure, the Auto Foil Outlet of your Hi-Float® Inflator will automatically shut off the helium flow.

For Inflating 14" or Larger Balloons



For inflating large balloons, slide the white ring over the outlet and screw to tighten. Stretch the neck of the balloon over the ring for hands-free inflation.

Inflator Maintenance

For best results, clean the helium and Hi-Float® outlet on a regular basis. This will insure that the proper amount of Hi-Float® and helium are added during the automatic inflation process.



1. Remove the blue helium supply line from the inflating outlet by pressing the gray plastic release ring. When the ring is fully depressed the hose can be easily removed from the fitting.



2. Fill the small squeeze bottle with hot water. Insert the blue hose on the end of the squeeze bottle into the helium outlet. Place a cup under the outlet to catch the hot water. Flush the passage with the hot water by squeezing the water bottle. This will dissolve any residual of Hi-Float® and clean the outlet.

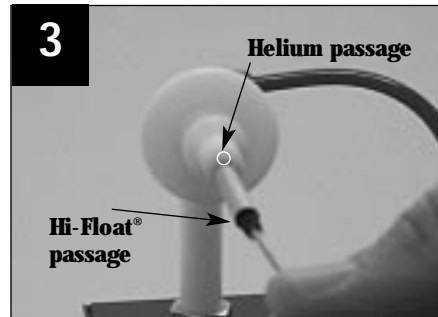

3. Use the small brush to clean the helium passage. Use the large brush to clean the Hi-Float® port. **Important Tip: Always cap the outlet when the unit is not in use. Hi-Float® will dry and clog the inflation outlet if the cap is not replaced when the unit is not in use.**

Related Products



Adhesive Grip-Strips

These sturdy plastic strips have adhesive backing to let you position them onto any clean surface. Great of POP displays!
Conwin #32070



Remote Helium Set-up

When your production area requires more helium, just turn the Cylinder Switch-Over Valve to replenish your helium supply.
Countertop Outlet #87000
Under-counter Outlet #87100



Grip-It Balloon Holder

The table-clamp and countertop models attach easily to any counter or other convenient location. Great for displays.
Table Clamp #32040
Counter Mount #32180



Under-Counter Ribbon Dispenser

This ribbon dispenser mounts to the Countertop Helium Outlet of your Remote Helium Set-up. A great way to get organized!
Conwin #49047



20-Spool Ribbon Rack

A compact, freestanding unit, featuring two ribbon cutters. With the top feed organizer, you can pull all the ribbons up at the same time! Durable steel.
Conwin #32100



V-Safe Helium Lock

Monitor your helium use. The V-safe fits right over the top of the cylinder and prevents unauthorized usage.
(Lock not included).
Conwin #32940

ConwinOnline.com

Our site features Conwin's complete line, balloon galleries, inspirational ideas, seasonal designs, step-by-step projects, and so much more.

Visit www.ConwinOnline.com today!



Online
Projects
Designs
Galleries
...and more!

Conwin's Tools of the Trade Video

Learn more about the entire line of Conwin products from the popular Precision Air Inflator to the spectacular Confetti Cannon! You'll also see many award-winning productions by leading balloon artists! Visit ConwinOnline.com's Education Center to see our complete line of videos.



CONWIN INC.
4510 Sperry Street • Los Angeles, CA 90039
Phone (323) 245-2842 FAX (818) 246-6862

ConwinOnline.com

Visit our online Retail Solutions Center!