



Precision Air Inflator Instruction Sheet

Precision Air Inflator Includes:

- 1 Precision Air Inflator
- 1 Power Cord
- 1 Foot Pedal
- 1 Carrying Case

Getting Started

- To prevent the risk of electrical shock, do not use the Precision Air Inflator outdoors when weather conditions are wet. Never operate unit on a wet floor or work area.
- Prior to plugging the Precision Air Inflator into an electrical outlet, verify that the electrical rating (listed on the label on the back of the Precision Air Inflator) is suitable for outlet.
- If the Precision Air Inflator malfunctions or is damaged in any way discontinue use and unplug unit from electrical outlet. Contact an authorized Conwin Service Center for details on how to receive service.
- Never attempt to repair the Precision Air Inflator yourself. Opening the Precision Air Inflator case will automatically void manufacturer warranty. Contact an authorized Conwin Service Center for all repairs.

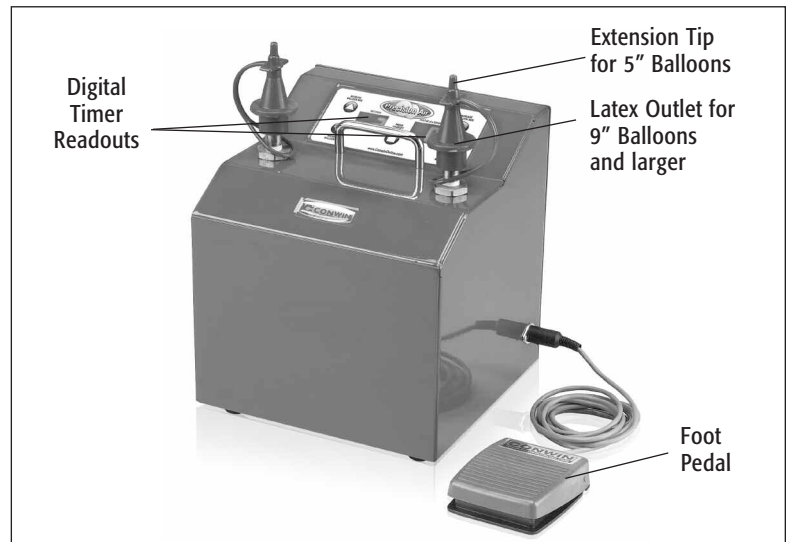

Plug the power cord into the side of the unit and into an electrical outlet. (A power strip with a surge protector is recommended.) The digital display will appear when unit has power.

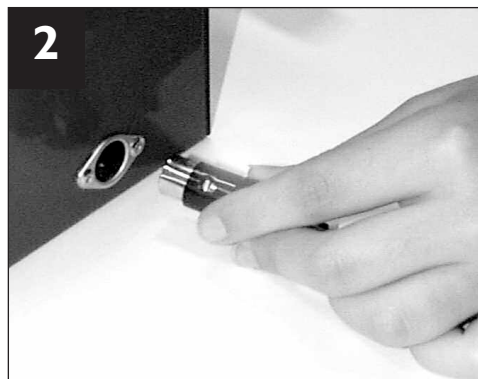

Plug the foot pedal into the side of the unit.

Setting the Precision Air Inflator

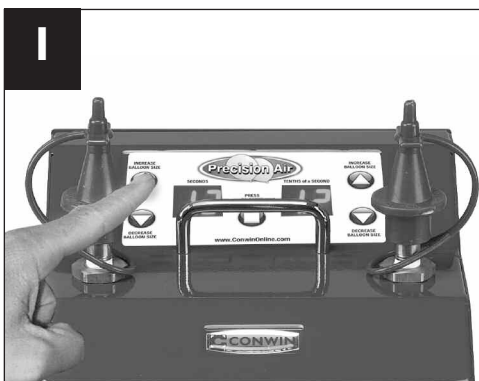

Reference the Time Setting Chart (Fig 1.0) to set the Precision Air for the proper balloon size. Set the appropriate number of Seconds by pressing the arrow buttons on the left side of the control panel digital display window. (Note: For 5" and smaller balloons, the second setting should be set at 00.)

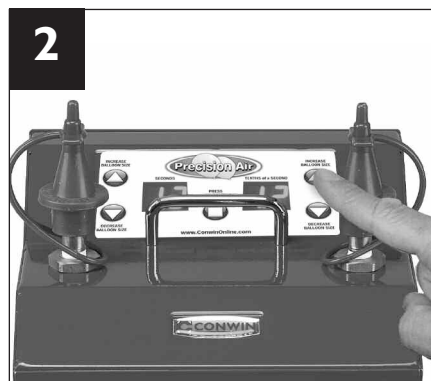

Set the appropriate number of Tenths of a Second by pressing the arrow buttons on the right side of the control panel digital display window.

Accessory Item

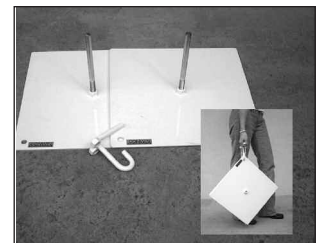

Baseplates

Conwin's 14-pound white base plates are powder-coated with an industrial paint finish. Uniquely designed base plates feature a rigging point for attaching archline, and a convenient carrying handle that holds 2 base plates and 2 risers. Allows user to transport up to 4 plates at a time (using 2 sets) - ideal for on-the-job decorating. Riser is designed to fit standard 1/2" electrical conduit.

Time Setting Chart (Fig 1.0)

| BALLOON SIZE | APPROX. TIME SETTING |
|--------------|----------------------|
| 5" BALLOON | 0.8 SECONDS |
| 9" BALLOON | 1.5 SECONDS |
| 11" BALLOON | 2.5 SECONDS |
| 16" BALLOON | 8 SECONDS |

The settings above should be used as guidelines for the Precision Air. Please note that size settings will vary based on user preference, balloon color, manufacturer and from unit to unit. To adjust the size of balloon to your individual preference it is necessary to inflate test balloons.

Inflating Balloons with the Precision Air Inflator

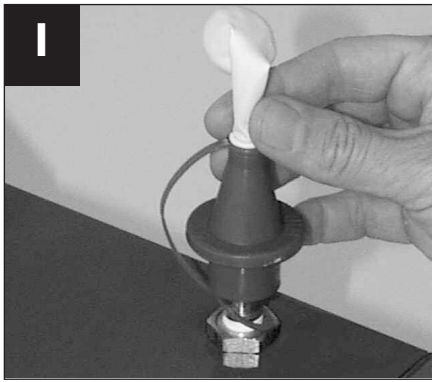

Place the extension tip over the filling outlet when inflating 5" balloons 260s. Place the neck of the balloon all the way down on the extension tip until the neck is touching the base of the tip.

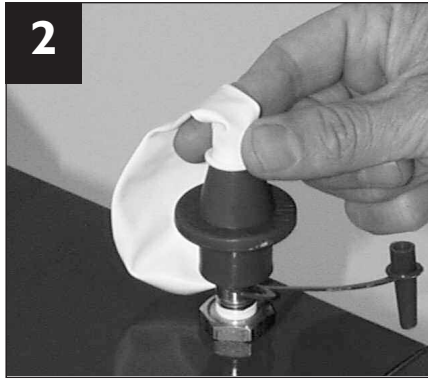

Remove the extension tip from the filling outlet when inflating 9" and larger balloons. Slightly roll the neck of the balloon over the inflating tip. This will insure the air enters the center of the balloon and the round shape of the balloon is maintained during the inflation process.



Tap the foot pedal to begin the inflation cycle. When the system automatically shuts-off, remove the balloons from the outlets without allowing any of the air to escape.



When inflating 260 balloons hold the balloon over the filling outlet and pull the end of the balloon upward to allow the air to enter into the balloon more easily.

Using and Resetting the Counter



- Every time the foot pedal is pressed the cycle count will be displayed on the digital display windows.
- The time setting for the inflation cycle will disappear once the foot pedal has been pressed. To verify or change the time setting for the inflation cycle, press any of the arrow buttons on the control panel once.
- The balloon time setting will be displayed on the digital window. Press the Reset button in the center of the control panel to set the counter back to zero.

Precautions:

1. The Precision Air features an automatic air vent that exhausts hot air out the bottom of the unit after each inflation cycle. To prevent the inflator from over-heating, use only one operator and allow the unit to fully exhaust the hot air between cycles.
2. For best results, operate the Precision Air in a temperature controlled environment. When working outdoors, keep the unit out of direct sunlight. If possible, avoid operating unit outdoors in extremely hot weather. If the unit reaches temperatures that exceed normal working conditions, the thermal shut-off control will automatically shut the system down. When the unit cools down to normal working conditions the system will reset and be ready for use.

Service & Warranty

For assistance with service & repair issues, or for warranty information, please visit ConwinOnline.com

03032009



CONWIN INC.
4510 Sperry Street • Los Angeles, CA 90039
Phone (818) 246-9233 FAX (818) 246-6862



Online
Projects
Designs
Galleries
...and more!

ConwinOnline.com

Learn More at ConwinOnline.com