

Service & Repair Procedures

Teflon Tape Installation / Leak Test / Gauge or Outlet Replacement / Auto-Fill Foil Outlet Replacement

Teflon Tape Installation

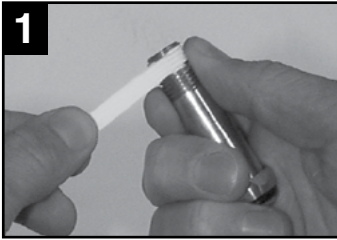

1. Hold the fitting between your thumb and forefinger. Place the Teflon tape on the second thread in from the end of the fitting first thread. Pinch the tape under your thumb and rotate the fitting counter clockwise. To apply a sufficient amount of tape rotate the fitting 3-4 full turns.

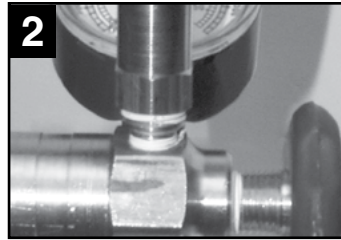

2. When tightening a Teflon wrapped fitting, leave approximately 2-3 threads exposed. This will prevent the fitting from restricting the flow.

Leak Test

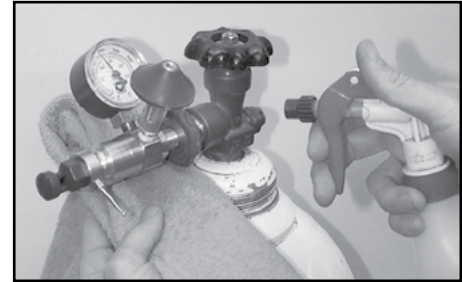

Connect inflator to a full cylinder. Slowly open valve and pressurize the inflator. Use a squirt bottle with a stream setting to apply a soapy-water mixture to each connection. Hold a rag behind the test area and spray a generous amount of the soapy water at the base of the connection. Bubbles will form in the water if the connection leaks.

Gauge or Outlet Replacement

Included in Gauge Repair Pack

- 1 - Pressure Gauge

Included in Outlet Repair Pack

- 1 - Outlet
- 1 - 1/8" to 1/4" Adaptor

Equipment Needed

- 5/8" Open End Wrench
- Pick

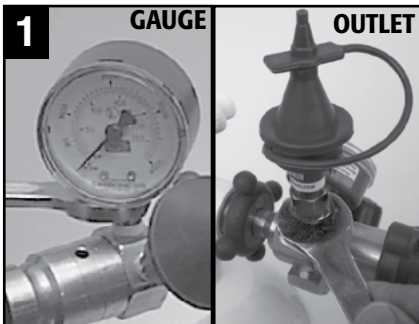

1. Attach the inflator to a cylinder; make sure the valve is closed and there is no pressure in the inflator. Rotate the regulator downward. Use a 5/8" open-end wrench to remove the outlet or pressure gauge.

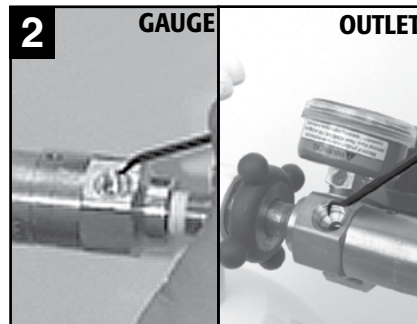

2. Make sure that the port is free of Teflon tape or metal particles after removing the outlet or pressure gauge.

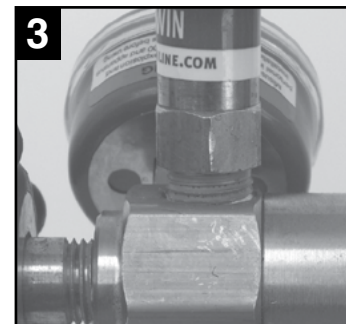

3. Leave approximately 2-3 threads exposed when tightening the new outlet or pressure gauge into the regulator. Leak check the connection under full pressure.

WARNING! Only replace gauge in same outlet as the original gauge was located in. Potential danger if Push Valve or Tilt outlet is installed in gauge port.

Auto-Fill Foil Outlet Replacement

Included in Repair Pack

- 1 - Auto-Fill Foil Outlet

Equipment Needed

- 5/8" Open End Wrench
- Pick

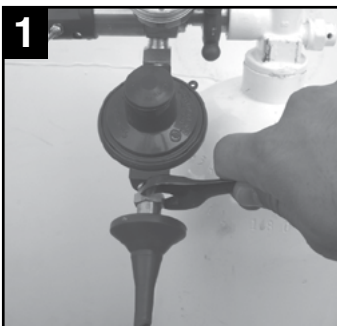

1. Attach the inflator to a cylinder; make sure the valve is closed and there is no pressure in the inflator. Rotate the regulator downward. Use a 5/8" open-end wrench to remove the Auto-Fill Foil Outlet.

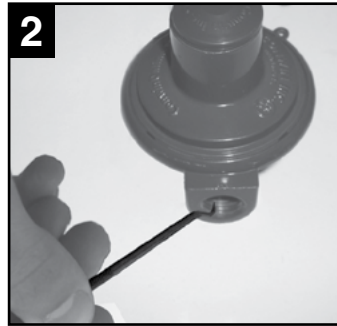

2. Make sure that the port is free of Teflon tape or metal particles after removing the outlet.



3. Leave approximately 2-3 threads exposed when tightening the new outlet or pressure gauge into the regulator. Leak check the connection under full pressure.

Ribbon Cutter Replacement

*For inflator models prior to 2005

Included in Repair Pack
• 4 - Ribbon Cutters

Equipment Needed
• Flat -Head Screw Driver
• Wrench
• Rubber Mallet

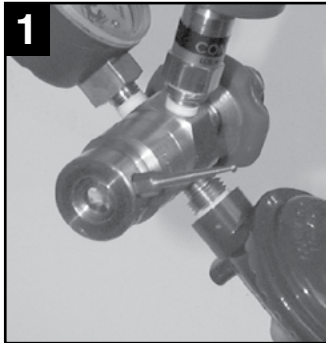

1. If the ribbon cutter is broken off completely, attach the inflator to a cylinder. Make sure the cylinder valve is closed and that there isn't pressure in the inflator.

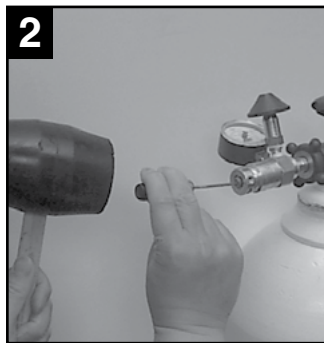

2. Use a rubber mallet to tap a small flat-head screwdriver into the remaining stub of the ribbon cutter. Carefully unscrew the broken end out of the ribbon cutter port.

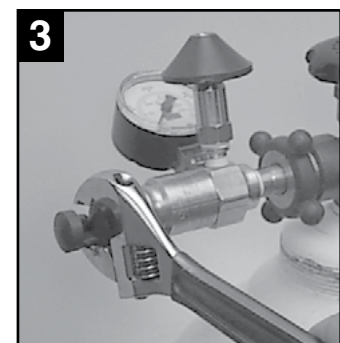

3. Use a wrench to lightly tighten the new ribbon cutter. Make sure to align the cutter with the blade pointing upward.

Ribbon Cutter Replacement

Current Model

Included in Repair Pack
• 1 - 2006 Ribbon Cutter
• 1 - Screw Cap
• 1 - Silver Ring
• 1 - 1/2" Screw

Equipment Needed
• Phillips Head Screw Driver
• Pick

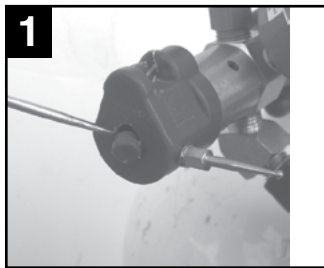

1. Attach the inflator to a cylinder. Make sure the cylinder valve is closed and that there isn't pressure in the inflator. Using a pick pry off the screw cap on the side of the ribbon cutter.



2. Using a phillips head screwdriver unscrew the scre connecting the ribbon cutter to the regulator.

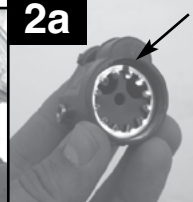

2a. Place the silver ring, with the black line indicator facing out, inside the new ribbon cutter and slide it back onto the regulator.

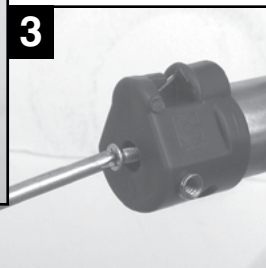

3. Screw the new screw into the ribbon cutter to connect the two together. Screw should be tightened firmly.

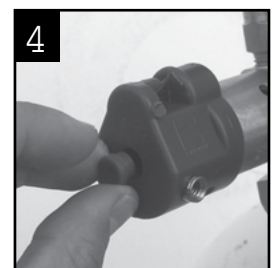

4. Slide the new screw cap into the side of the cutter.

O-Ring Replacement

Included in Repair Pack
• 6 - O-Rings
Equipment Needed
• Pick

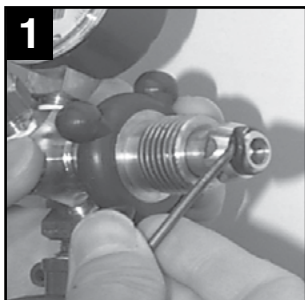

1. Remove the O-ring from the groove with a pick

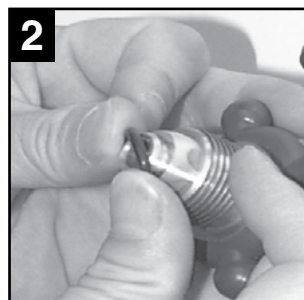

2. Use spray silicone to lubricate the new O-ring and press fit over tip of nipple into the groove.

Disc Tyer Post Replacement

Included in Repair Pack
• 1 - Disc Tyer Post
Equipment Needed
• Pliers • Hammer or Drill

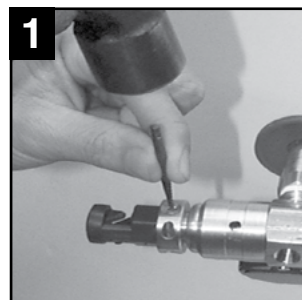

1. Attach the inflator to a cylinder; make sure the valve is closed and there is no pressure in the inflator. If the disc tyer post is broken off completely, drill a small pilot hole in the end of the broken disc tyer. Tap a easy-out bit into the pilot hole.

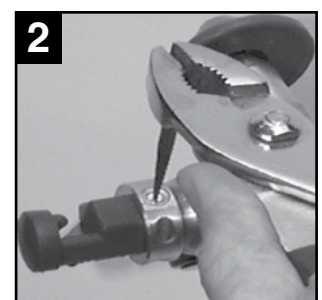

2. Use a plier to rotate the easy-out counter clockwise to remove the broken piece.