

**Cylinder Safety Stand Includes:**

- 2 Velcro® Safety Belts
- 1 Cylinder Baseplate
- 1 Cylinder Upright Support
- 2 Bolts (in Cylinder Upright Support)
- 1 Wrench

Assembling the Safety Stand

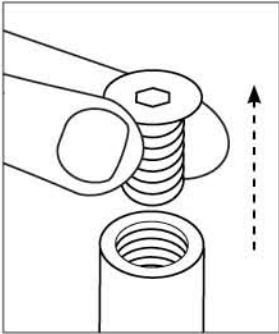

STEP 1. Remove the bolts from the base of the safety stand Upright Support.

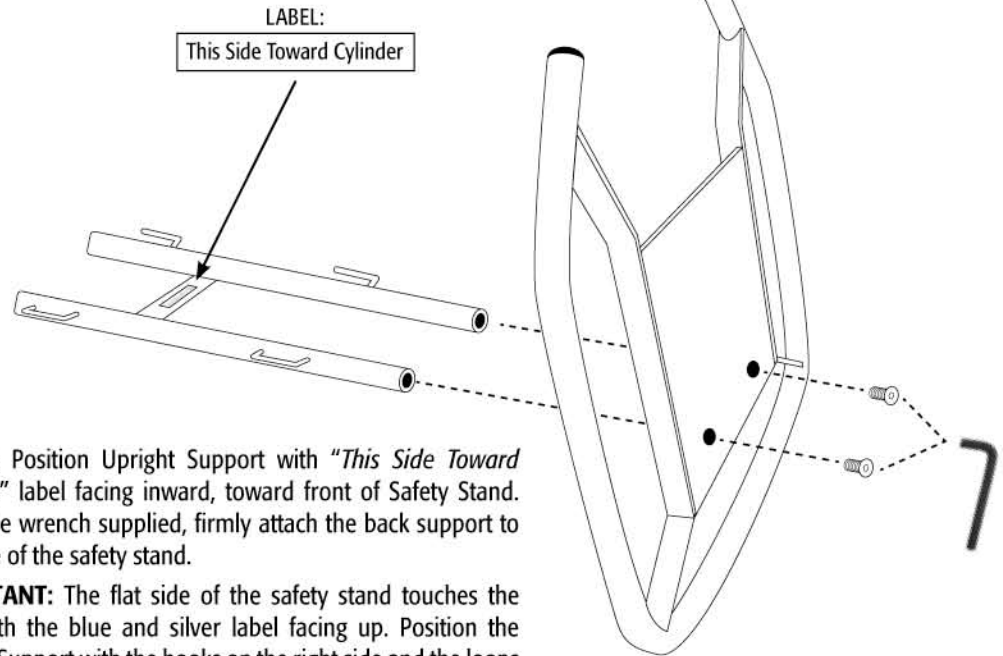

STEP 2. Position Upright Support with "This Side Toward Cylinder" label facing inward, toward front of Safety Stand. Using the wrench supplied, firmly attach the back support to the base of the safety stand.

IMPORTANT: The flat side of the safety stand touches the floor with the blue and silver label facing up. Position the Upright Support with the hooks on the right side and the loops on the left side.

Securing the Safety Belts

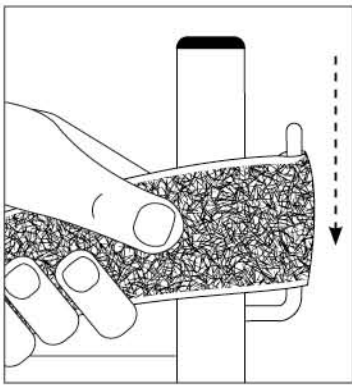

Step 3. Place Velcro® Safety Belt on hook with fuzzy side facing outward.

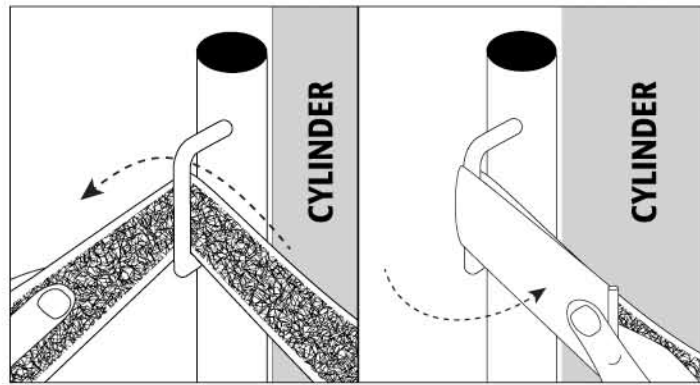

Step 4. Roll the cylinder into the safety stand until it is touching the upright supports. Orient cylinder valve outlet so it is facing to the left. Place bottom Velcro® Safety Belt around cylinder and through loop. Tighten belt securely. Repeat with top belt. Cylinder should be very tightly attached to stand.

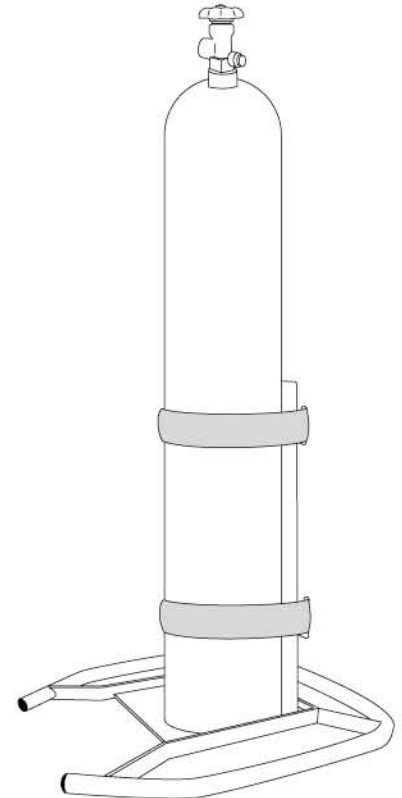

Service & Warranty

For assistance with service & repair issues or for warranty information, please visit ConwinOnline.com, or call (818)-246-9233